

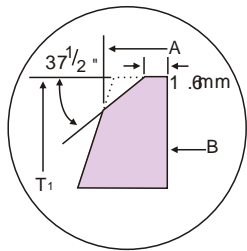

ANSI B16.47 SERIES B CLASS 300 FLANGES

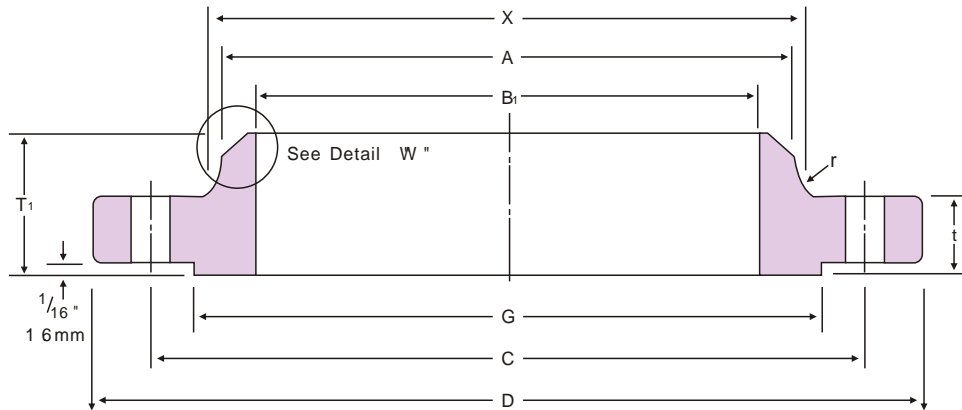

Detail W "
Typical Welding
end Preparation



Unit :mm

Nominal Pipe Size	Outside Diam .	O .D. of Raised Face	Diam . at Base of Hub	Diam . at Base of Hub	BORE			Length Thru Hub	Thick - ness	Radius at Base of Hub	DRILLING			Approximate Weight Pounds (kg)			
					Wall Thickness						T1	t	r		Bolt Circle Diam .	Number of Holes	Diam . of Holes
					6.35mm	9.5mm	12.7mm										
26	867	736.6	701.5	665.2	647.7	641.4	635.0	144.5	88.9	14.2	803.1	32	35.1	440.9 (200.17)			
28	921	787.4	755.7	716.0	698.5	692.2	685.8	149.4	88.9	14.2	857.3	36	35.1	463.0 (210.20)			
30	991	844.6	812.8	768.4	749.3	743.0	736.6	158.0	93.7	14.2	920.8	36	38.1	595.2 (270.22)			
32	1054	901.7	863.6	819.2	800.1	793.8	787.4	168.1	103.1	15.7	977.9	32	41.1	727.5 (330.29)			
34	1108	952.5	917.4	870.0	850.9	844.6	838.2	173.0	103.1	15.7	1031.7	36	41.1	793.7 (360.34)			
36	1171	1009.7	965.2	920.8	901.7	895.4	889.0	180.8	103.1	15.7	1089.2	32	44.5	903.9 (410.37)			
38	1222	1060.5	1016.0	971.6	952.5	946.2	939.8	192.0	111.3	15.7	1140.0	36	44.5	1256.6 (570.50)			
40	1273	1114.6	1066.8	1022.4	1003.3	997.0	990.6	198.4	115.8	15.7	1190.8	40	44.5	1455.0 (660.57)			
42	1334	1168.4	1117.6	1074.7	1054.1	1047.8	1041.4	204.7	119.1	15.7	1244.6	36	47.8	1587.3 (720.63)			
44	1384	1219.2	1173.2	1125.5	1104.9	1098.6	1092.2	214.4	127.0	15.7	1295.4	40	47.8	1763.7 (800.72)			
46	1461	1270.0	1128.9	1176.3	1155.7	1149.4	1143.0	222.3	128.5	15.7	1365.3	36	50.8	2138.5 (970.88)			
48	1511	1327.2	1277.9	1227.1	1206.5	1200.2	1193.8	223.8	128.5	15.7	1416.1	40	50.8	2182.5 (990.86)			
50	1562	1378.0	1330.5	1277.9	1257.3	1251.0	1244.6	235.0	138.2	15.7	1466.9	44	50.8	2308.2 (1047.92)			
52	1613	1428.8	1382.8	1328.7	1308.1	1301.8	1295.4	242.8	142.7	15.7	1517.7	48	50.8	2453.3 (1113.79)			
54	1673	1479.6	1435.1	1379.5	1358.9	1352.6	1346.2	239.8	136.7	15.7	1577.8	48	50.8	2557.3 (1161.01)			
56	1765	1536.7	1493.8	1422.4	1409.7	1403.4	1397.0	268.2	153.9	17.5	1651.0	36	60.5	2942.9 (1336.01)			
58	1827	1593.9	1547.9	1481.1	1460.5	1454.2	1447.8	274.6	153.9	17.5	1712.0	40	60.5	3144.5 (1427.60)			
60	1878	1651.0	1598.7	1531.9	1511.3	1505.0	1498.6	271.5	150.9	17.5	1763.8	40	60.5	3196.7 (1451.30)			

Notes

- (1) "Bore" (B1) of flanges is shall be specified by the purchaser.
- (2) Class 300 flanges will be furnished with 0.06" (1.6mm) raised face ,which is included in "Thickness" (t) and "Length through Hub" (T1)