

ANSI B16.47 SERIES A

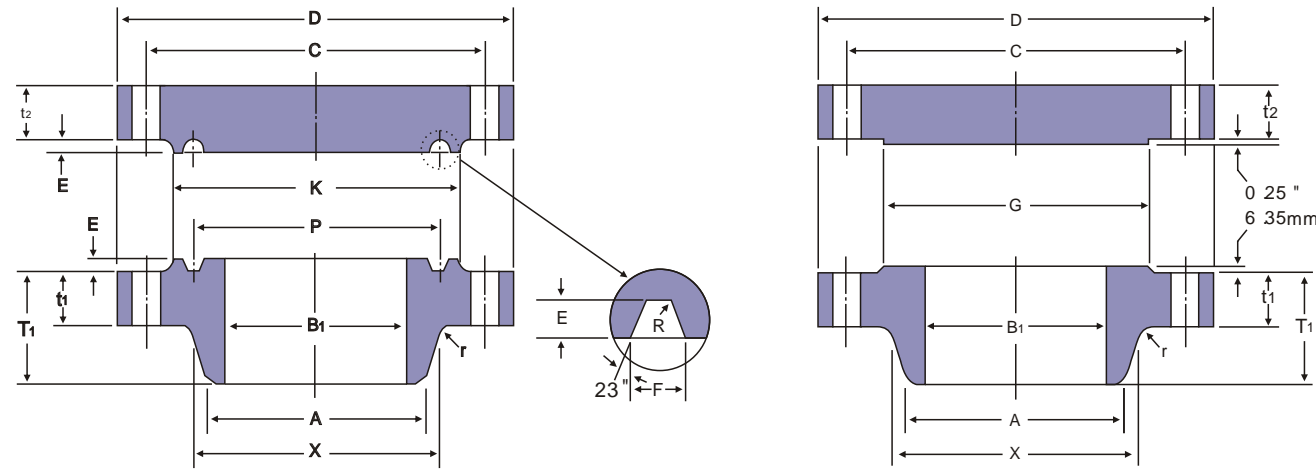

ANSI B16.47 SERIES A
WELDING-ENDS FOR WELDING-NECK FLANGES

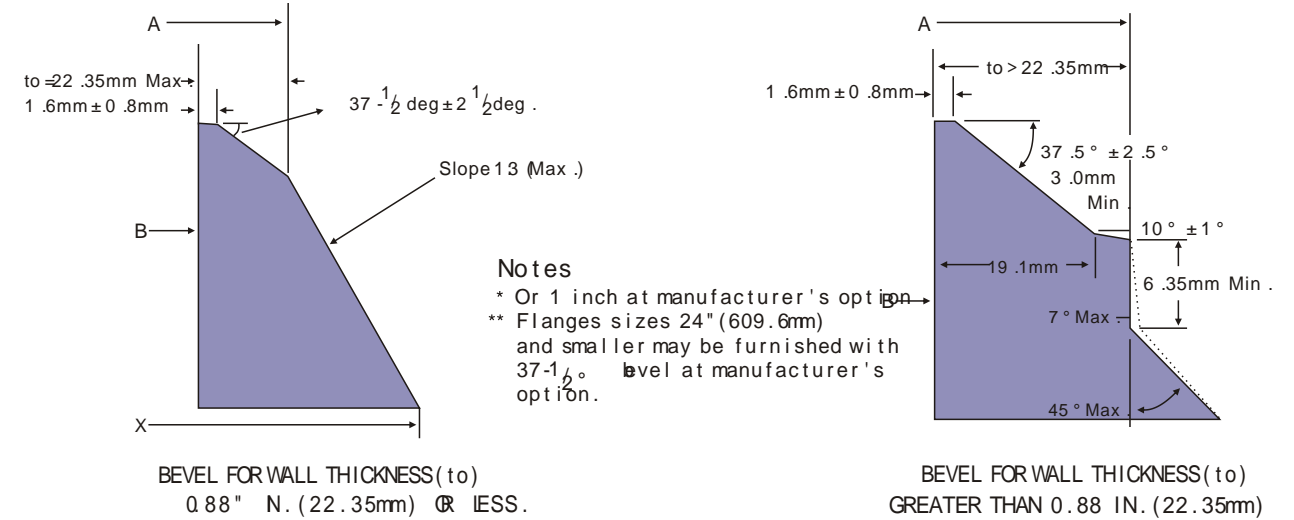

Unit :mm

Nominal Pipe Size	Outside Diam .	Diam . at Base of Hub	O .D .of Raised Face	Thickness		BORE		Length Thru Hub	Diam . of Hub at Bevel	Radius of Fillet
				Welding Neck	Blind	Wall Thickness				
						9 .5mm	12 .7mm			
D	X	G	t1	t2	B1	T1	A	r		
12	610	419.1	381.0	79.2	79.2	304.8	298.5	200.2	323.9	11.2
14	641	450.9	412.8	85.9	85.9	336.6	330.2	212.9	355.6	11.2
16	705	508.0	469.9	88.9	88.9	387.4	381.0	215.9	406.4	11.2
18	787	565.2	533.4	101.6	101.6	438.2	431.8	228.6	457.2	11.2
20	857	622.3	584.2	108.0	108.0	489.0	482.6	247.7	508.0	11.2
24	1041	749.3	692.2	139.7	139.7	590.6	584.2	292.1	609.6	11.2
26	1086	774.7	749.3	139.7	160.3	641.4	635.0	285.8	676.4	11.2
28	1168	831.9	800.1	142.7	171.5	692.2	685.8	298.5	728.7	12.7
30	1232	889.0	857.3	149.4	182.4	743.0	736.6	311.2	781.1	12.7
32	1314	946.2	914.4	158.8	193.5	793.8	787.4	330.2	831.9	12.7
34	1397	1006.3	965.2	165.1	204.7	844.6	838.2	349.3	884.2	14.2
36	1461	1063.8	1022.4	171.5	214.4	895.4	889.0	362.0	936.8	14.2
38	1461	1073.2	1098.6	190.5	215.9	946.2	939.8	352.6		19.1
40	1511	1127.3	1162.1	196.9	223.8	997.0	990.6	363.5		20.6
42	1562	1176.3	1212.9	206.2	231.6	1047.8	1041.4	371.3		20.6
44	1648	1234.9	1270.0	214.4	242.8	1098.6	1092.2	390.7		22.4
46	1734	1292.4	1333.5	225.6	255.5	1149.4	1143.0	411.0		22.4
48	1784	1343.2	1384.3	233.4	263.7	1200.2	1193.8	419.1		23.9

Notes

- (1) For the 'Bore' (B1) other than Wall thickness 0.375" (9.5mm) and 0.500" (12.7mm), refer to page 60.
- (2) Class 600 flanges will be furnished with 0.25" (6.35mm) raised face, which is included in "Thickness" (t) and "Length through Hub" (T1)
- (3) Dimensional tolerance are in accordance with ANSI B16.5

Unit :mm

Nominal Pipe Size	DRILLING			Pitch Diam .	GROOVE DIMENSIONS			Diam . of Raised Face	Ring and Groove Number
	Bolt Circle Diam .	Number of Holes	Diam . of Holes		Width	Depth	Radius		
12	533.4	20	38.1	381.0	11.9	7.9	0.8	419.1	R57
14	558.8	20	41.1	419.1	16.7	11.1	1.5	466.9	R62
16	616.0	20	44.5	469.9	16.7	11.1	1.5	523.7	R66
18	685.8	20	50.8	533.4	19.8	12.7	1.5	593.9	R70
20	749.3	20	53.8	584.2	19.8	12.7	1.5	647.7	R74
24	901.7	20	66.5	692.2	27.0	15.9	2.3	771.7	R78
26	952.5	20	73.2	749.3	30.2	17.5	2.3	831.9	R100
28	1022.4	20	79.2	800.1	33.3	17.5	2.3	889.0	R101
30	1085.9	20	79.2	857.3	33.3	17.5	2.3	946.2	R102
32	1155.7	20	85.9	914.4	33.3	17.5	2.3	1003.3	R103
34	1225.6	20	91.9	965.2	36.5	20.6	2.3	1066.8	R104
36	1289.1	20	91.9	1022.4	36.5	20.6	2.3	1124.0	R105
38	1289.1	20	91.9						
40	1339.9	24	91.9						
42	1390.7	24	91.9						
44	1463.5	24	98.6						
46	1536.7	24	104.6						
48	1587.5	24	104.6						

- (4) Maximum Pressure Rating for raised face flanges is 2220 psi (153.1 BARS) at atmospheric temperature.
- (5) Flange dimensions of size 12" (304.8mm) through 24" (609.6mm) flanges except 22" (558.8mm) are in accordance with ANSI B 16.5.
- (6) For sizes 26" (660.4mm) and larger, Diameter of Hub at Bevel (A) are in accordance with ASME Boiler and pressure vessel code.