

ANSI B16.47 SERIES A

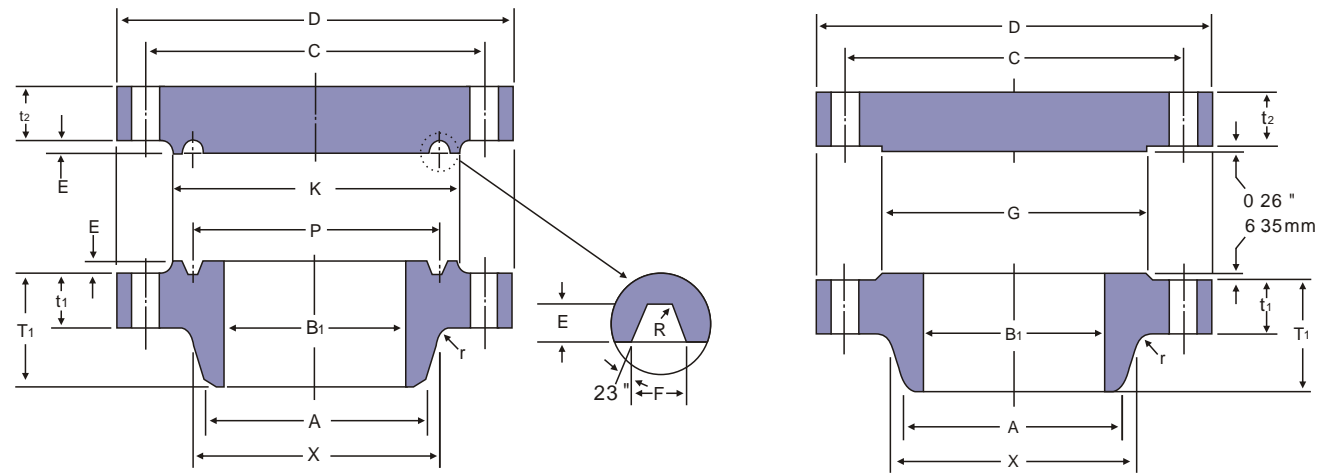

ANSI B16.47 SERIES A
WELDING-ENDS FOR WELDING-NECK FLANGES

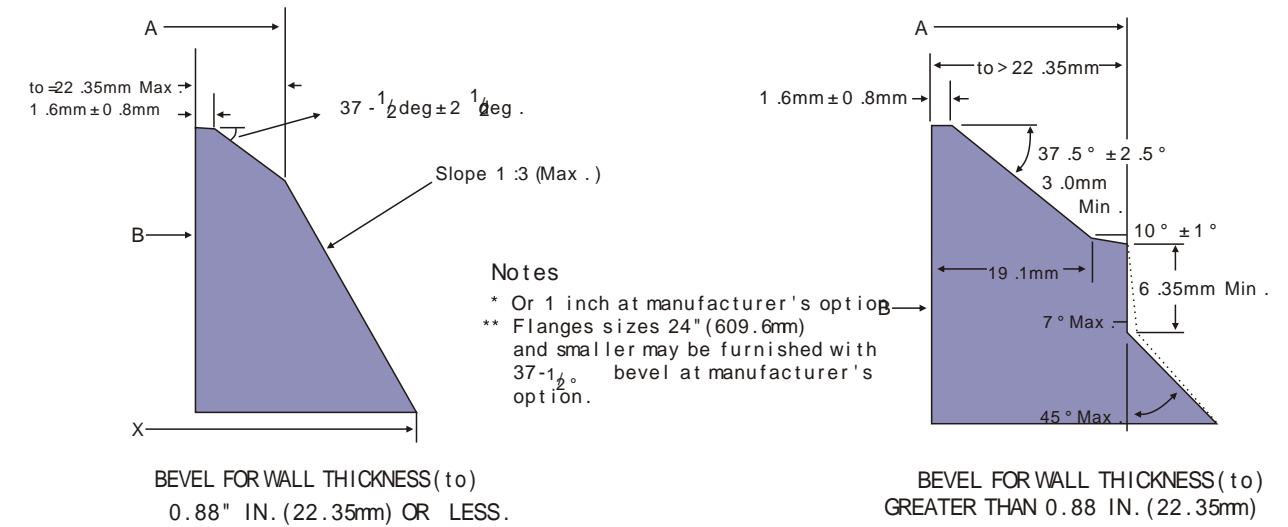

Unit :mm

Nominal Pipe Size	Outside Diam . D	O .D .of Raised Face G	Diam . at Base of Hub X	Thickness		BORE		Length Thru Hub T1	Diam . of Hub at Bevel A	Radius of Fillet r
				Welding Neck t1	Blind t2	Wall Thickness				
						9.5mm B1	12.7mm			
12	521	381.0	374.7	57.2	57.2	304.8	298.5	136.7	323.9	11.2
14	584	412.8	425.5	60.5	60.5	336.6	330.2	149.4	355.6	11.2
16	648	469.9	482.6	63.5	63.5	387.4	381.0	152.4	406.4	11.2
18	711	533.4	533.4	66.5	66.5	438.2	431.0	165.1	457.2	11.2
20	775	584.2	587.2	69.9	69.9	498.0	482.6	168.1	508.0	11.2
22	838	641.4	641.4	73.2	73.2	539.8	533.4	171.5	558.8	11.2
24	914	692.2	701.5	76.2	76.2	590.6	584.2	174.8	609.6	11.2
26	972	749.3	726.9	88.9	98.6	641.4	635.0	193.5	668.5	11.2
28	1035	800.1	782.6	95.3	104.6	692.2	685.8	206.2	719.3	12.7
30	1092	857.3	836.7	101.6	111.3	743.0	736.6	218.9	770.1	12.7
32	1149	914.4	889.0	108.0	115.8	793.8	787.4	231.6	822.5	12.7
34	1207	965.2	944.6	111.3	122.2	844.6	838.2	241.3	873.3	14.2
36	1270	1022.4	1000.3	114.3	128.5	895.4	889.0	251.0	925.6	14.2
38	1207	1035.1	1003.3	124.0	124.0	946.2	939.8	206.2		14.2
40	1270	1092.2	1054.1	130.0	130.0	997.0	990.6	215.9		14.2
42	1321	1143.0	1107.9	133.4	133.4	1047.8	1041.4	223.8		14.2
44	1384	1200.2	1158.7	139.7	139.7	1098.6	1092.2	233.4		14.2
46	1441	1257.3	1212.9	146.1	146.1	1149.4	1143.0	244.3		14.2
48	1511	1308.1	1267.0	152.4	152.4	1200.2	1193.8	257.0		14.2
50	1568	1361.9	1320.8	157.2	158.8	1251.0	1244.6	268.2		14.2
52	1619	1412.7	1371.6	162.1	163.6	1301.8	1295.4	276.4		14.2
54	1702	1470.2	1425.4	169.9	171.5	1352.6	1346.2	289.1		14.2
56	1753	1527.0	1479.6	174.8	176.3	1403.4	1397.0	298.5		14.2
58	1803	1577.8	1530.4	177.8	180.8	1454.2	1447.8	306.3		14.2
60	1886	1635.3	1584.5	185.7	189.0	1505.0	1498.6	319.0		14.2

Notes:
(1) For the 'Bore' (B1) other than Wall thickness 0.375" (9.5mm) and 0.500" (12.7mm), refer to page 60.
(2) Class 400 flanges will be furnished with 0.25" (6.4mm) raised face, which is included in "Thickness" (t) and "Length through Hub" (T1)
(3) Dimensional tolerance are in accordance with ANSI B16.5

Unit :mm

Nominal Pipe Size	DRILLING			Pitch Diam . P	GROOVE DIMENSIONS			Diam . of Raised Face K	Ring and Groove Number
	Bolt Circle Diam . C	Number of Holes	Diam . of Holes		Width	Depth	Radius		
					F	E	R		
12	450.9	16	35.1	381.0	11.9	7.9	0.8	412.8	R57
14	514.4	20	35.1	419.1	11.9	7.9	0.8	457.2	R61
16	571.5	20	38.1	469.9	11.9	7.9	0.8	508.0	R65
18	628.7	24	38.1	533.4	11.9	7.9	0.8	574.5	R69
20	685.8	24	41.1	584.2	13.5	9.5	1.5	635.0	R73
22	743.0	24	44.5	635.0	15.1	11.1	1.5	685.8	R81
24	812.8	24	47.8	692.2	16.7	11.1	1.5	749.3	R77
26	876.3	28	47.8	749.3	19.8	12.7	1.5	809.8	R93
28	939.8	28	50.8	800.1	19.8	12.7	1.5	860.6	R94
30	997.0	28	53.8	857.3	19.8	12.7	1.5	917.4	R95
32	1054.1	28	53.8	914.4	23.0	14.3	1.5	984.3	R96
34	1104.9	28	53.8	965.2	23.0	14.3	1.5	1035.1	R97
36	1168.4	32	53.8	1022.4	23.0	14.3	1.5	1092.2	R98
38	1117.6	32	47.8						
40	1174.8	32	50.8						
42	1225.6	32	50.8						
44	1282.7	32	53.8						
46	1339.9	36	53.8						
48	1403.4	28	60.5						
50	1460.5	32	60.5						
52	1511.3	32	60.5						
54	1581.2	28	66.5						
56	1632.0	32	66.5						
58	1682.8	32	66.5						
60	1752.6	32	73.2						

(4) Maximum Pressure Rating for raised face flanges is 985 psi (68 BARS) at atmospheric temperature.
(5) Flange dimensions of size 12" (304.8mm) through 24" (609.6mm) flanges except 22" (558.8mm) are in accordance with ANSI B 16.5.
(6) For sizes 26" (660.4mm) and larger, Diameter of Hub at Bevel (A) are in accordance with ASME Boiler and pressure vessel code.